

Its all systems GO for the new Community Hall

Parish Council gives the **GREEN** Light to build the Costessey Centre

At long last the Parish Council can announce that a new hall to be called the **Costessey Centre** will be built on Longwater Lane Recreation Ground.

The decision to announce the news was delayed while a grant request from the Football Foundation was being processed. Confirmation came through on the 29th June that the Parish Council had successfully bid for £222,591 meaning that the whole building can be completed. Assuming all goes to plan, the Council Chairman will sign the contracts in late July following pre-constuction meetings with the contractors Morgan Ashurst. Building could commence in mid August when the old pavilion will be demolished. The existing car park will be closed and replaced by hard surface car parking for 76 cars. The tennis courts will be opened as a temporary car park.

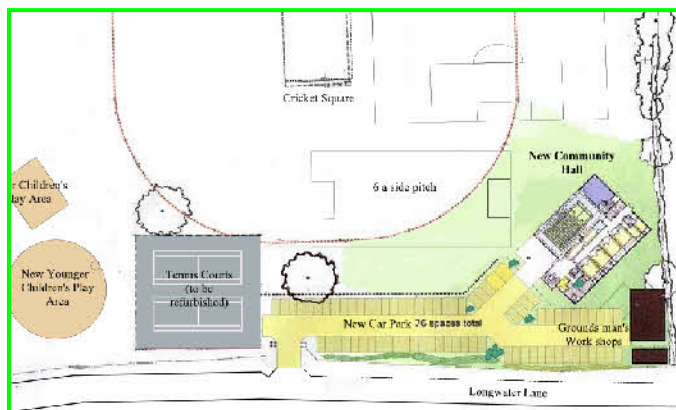

Longwater Lane Recreation Ground - The Final Project

Designed for community use

Built to a modern design, two signature features will mark the Centre's identity: the south west facing wall will be constructed from Kalwall, an energy efficient material that diffuses light making the interior feel light and airy; and secondly, the 1st floor concourse with casual seating that will offer full vision of activities in the main hall. The Centre will boast a large main hall measuring 18m x 10.5m, four modern changing rooms, two kitchens, store areas, community rooms, council offices and a lift.

Funding opportunities

The hall, demolition of the pavilion and car park will cost £1,255,991. Of this, £1m is financed from a low rate (3.6%) 25 year loan from the Public Loans Board. Other major sources of funding include the Football Foundation grant already mentioned, £95,611 from the Dept of Children, Families and Schools, £20,000 from NEWS, £5000 from South Norfolk Council and £2400 from user groups. The remainder will come from Parish Council Reserves.

“ If we cannot help you, we will try and find someone who can.”

What now?

The project will take 9 months to complete. The Council hopes to take possession of the Centre in April 2010 and has ear-marked the Spring Bank Holiday - 31st May 2010 - for an official opening. There are plans to hold a summer fayre, concert or similar event to mark what has to be a special day in Costessey's history.

Comment - From the Editor

Many doubted it, more said it couldn't or wouldn't be done, Yet, after more than three decades of waiting, it is about to happen: a brand new, exciting, purpose built community centre in what is now the geographical heart of the parish.

And why not? Costessey is a major parish within South Norfolk rivaling towns such as Wymondham and Diss. Few town and parishes can boast such diverse endeavours - everything from hosting the County's showcase - the Royal Norfolk Showground to more down to earth undertakings such as extensive gravel workings. Costessey people deserve to enjoy first class facilities.

Now, all we need is the powers that be in County Hall to understand that a ¾ Northern Distributor Road is useless to Costessey. If there is to be a new road, the link between the Fakenham Rd to the Southern By Pass is a must.

Another 30 year wait maybe! Let's hope not.

Annual General Meeting - Chairman's Report

Costessey Centre. Year on year for many years now the replacement of the Sports Pavilion on Longwater Lane Recreation Ground has featured in these reports as the Parish Council has tried to replace the very dilapidated building. At last I can report there is light at the end of the tunnel and quite a strong light at that! I can tell you the building is designed and has received a great deal of public support: planning permission has been given: tenders have been sought and received: a preferred bidder has been identified. All that remains is to finalise the funding.

Originally the Parish Council planned to fund the estimated £2million project in a variety of ways. It had £100,000 on deposit which it had saved over the years; £500,000 from a planning gain attached to the Lodge Farm (now called Fairhaven) development: the sale of redundant buildings and grant aid. The current economic situation has meant that some radical rethinking has had to take place although it is not all is bad news. One point of good news is that the tender has come in significantly lower than originally envisaged – around £1.4 million. However, despite numerous applications, grant funders willing to consider the project are few and far between. So far £20,000 has been received from NEWS and £5000 from South Norfolk Council and decisions are still awaited from a number of other organisations the largest of which is the Football Foundation to whom we are applying for £222,000. The £500,000 from the Lodge Farm development will be

paid on the occupation of the 200th dwelling. The slow down in house sales means that, although still assured, it may be some time before the Parish Council is in receipt of this money. Also the redundant buildings, even if they sold, would be at a lower price than previously valued. Recognising that the old Pavilion has to go and after a great deal of deliberation the Parish Council has decided to borrow £1million so that at least part of the project can go ahead. However, for the complete building to be constructed we still need to be successful in our application to the Football Foundation and we are very hopeful it will be. We shall know by the end of June. A further benefit of the current economic situation is that the Parish Council has been able to get a very favourable rate if interest on the first £500,000 it has already received (3.66%) and is likely to get the second £500,000 at least this rate or even below. As and when the other funds come forward the Parish Council will then consider whether to use them to pay back some or all of the loans dependent on the amounts.

Queens Hills. The Land Developer at Queens Hills, Cofton Ltd, went into receivership earlier this year which created a number of problems. However, we are assured the entire infrastructure costs are insured so will definitely be provided. The Parish Council have been working with the Queens Hills Residents Group to lobby for a number of the issues on the site to be resolved as soon as possible. However, there is still no definite decision on where the Community Centre for the development will finally be sited but planners at South Norfolk are working with representatives of the site, the Queens Hills Residents Group and the Parish Council to try to identify the options so this can move forward as soon as possible.

New Surgery for Costessey. The Doctors practice on Longwater Lane has received planning permission for a new surgery on the site of the old Roundwell Public House. This is expected to be built and opened in 2010. Whilst some residents have concerns about the closure of both the surgery at Longwater Lane and the satellite in Valley Road it is appreciated that the new facility will offer excellent modern facilities for its patients. The surgery was part of a larger application which included 49 dwellings on the field adjacent to the Roundwell Public House. This development has a mutual boundary with the Parish Cemetery and the Parish Council is to be given a strip of land 10 metres wide for the length of the boundary to use as an extension to the Parish Cemetery.

Suggestion for Unitary Local Government for Norfolk. The Government has asked the Boundary Committee to look at possible options for Unitary Local Government in Norfolk and – after examining various suggestions - it has consulted on two options, one Council for the County or two Councils, one for a

Greater Norwich and one for the remainder of the County. Whilst the Parish Council is not opposed to unitary authorities per sé it has commented that it feels neither option put forward so far are right for Norfolk.



Local Development Framework – Joint Core Strategy. A recent public consultation on this showed that so many landowners and developers in Costessey have asked that their land be considered for inclusion in this document for development that, were they all to be included, Costessey would have very little green space left! The Parish Council has argued that of the 1000 new homes which have been allocated in this document to be built in Costessey and Easton, Costessey is already getting some 400 given the additional 350 or so envisaged at Queens Hills over the original plan, 49 recently approved on land attached to the Roundwell Public House and 5 recently approved in Norwich Road. Therefore the remainder of this 1000 should be sited in Easton. However, the Parish Council is aware there is still 1800 dwellings required which have yet to be allocated to an area and it appreciates, given the position of Costessey, that it is likely to be allocated some of these. The Parish Council has therefore said it would be mindful to support (subject to design, layout and community benefit) an extension of the Lodge Farm site up to the line of the road to the old Lodge Farm to accommodate its share of this odd 1800. The Parish Council did not support any of the other sites landowners have put forward for consideration. South Norfolk Council will now assess the responses and propose sites for development which will be the subject of the next consultation.

Traffic Calming in Old Costessey. Residents have felt that neither of the traffic calming schemes in The Street and West End have been completely successful for various reasons. The Parish Council has been pressing for additional measures for both areas and, with the active support of Costessey County Councillor, Tim East, has been successful in winning further funding from Norfolk County Council. The proposals – which include additional traffic humps, including two in Folgate Lane, parking restrictions, build-outs and additional footway and footway road markings - are not completely finalised as yet but it is hoped some if not all the measures will be installed in Spring 2010.

Anglian Water additional water pipeline. Officers from Anglian Water have been liaising with the Parish Council about a multi-million pound water pipeline and treatment works scheme in Costessey. The pipe will run from Costessey pits through Costessey to Sweet Briar Road in Norwich and beyond and is being installed to ensure the continuity of the water supply to Norwich and its surrounds. The treatment works is to be on the edge of East Hills Wood behind properties in The Loke off Longwater Lane and are to be very well screened to protect the Tud valley views. Work has already begun and there is expected to be some disruption to traffic when the pipe is laid in a small section of West End and Townhouse Road.

Planting the Oval Road roundabout. As a result of an approach by the Costessey Tree Warden, Colin Traverse, and after consultation with the 'neighbours' of the roundabout, the Parish Council has applied for a licence to plant around five trees on it. The trees are likely to be a mixture of Rowan and Birch and will be planted and kept so they do not restrict the visibility across the roundabout.

Parish Council Open Day The Parish Council recently held its annual Open Day in the Parish Rooms with displays on many of the topics I have mentioned in my report. Although not quite as well attended as previous Open Days, many of those who did attend were keen to discuss the displays and other issues relating to Costessey with both Councillors and staff.

Once again I would like to end my report with my sincere thanks to my fellow Councillors and the Council staff for all their hard work and support during the year.

William Dinneen
Chairman of Costessey Parish Council
19th May 2009

Annual Parish Assembly Clerks Report - Finance Report for 2008/9

The overall Income and Expenditure report as at 31st March 2009 is available on the Parish Council web site. The overall balance on the General Fund is high – almost £592,000 of which £500,000 is the loan drawn down on 19th March 2009 towards the Costessey Centre project. £495,060 has been transferred to earmarked reserves, namely the Costessey Centre Fund, leaving almost £97,000 on the General Fund – still almost £40,000 less than the recommended carry forward level.

All the figures are subject to audit.

Vegetation overhanging footways

Can we appeal, yet again, to all parishioners to check that their hedges and trees with over hanging branches are not obstructing footways and paths.

The parish office and councillors receive a constant stream of complaints that paths are dangerous forcing pedestrians to walk onto the road.



Please check your hedges and trees for potential problems.

New Community Forum on Parish web site

Parishioners who feel strongly about issues in Costessey might like to access the Community Forum Page on the Parish Council Web site. (www.costessey.org.uk)

Simply log on using your own password and you can have your say. Please remember that the facility is designed to provide a forum for discussion and that views should remain polite even if controversial.

There are a number of topics to comment on such as housing in Costessey and the new Community Centre. There is also a general section for any other topics.

We can help you improve your health?



A new service supporting people for those: over 60, under 60 who are on income related benefits, who are disabled or have a long term health condition. The Health Connectors service uses volunteers to help people who want to make changes such as improving their diet and doing more exercise, and the response has been very encouraging with 30 of the target 36 volunteers recruited to date.

This free service can help people:

- Reduce their risk of a fall
- Improve their general fitness
- Quit smoking
- Manage their diet and weight

Health Connectors are trained volunteers who provide up to six visits to someone who wants to improve their health. This involves working with the client to set easy and realistic goals as well as provide the information and support that they need to make a health change. This free service is available to

For more information on the Health Connectors Service please contact the Health Connectors Coordinator on 01603 883847.

Health Connectors is a service run by Voluntary Norfolk and funded by NHS Norfolk.

Do you need help to arrange small jobs around the house?

South Norfolk Council launched its Handy Person Service on 1st June this year for those on a means tested benefit, over 60, registered disabled or suffering from long-term ill health. The service offers reasonably priced repairs and little jobs around the house using local contractors.

The cost is £10 per hour plus materials for small jobs such as fixing rails, easing doors, moving furniture, changing light bulbs. For jobs taking more than one hour there is an additional £10 charge.



No job likely to be over two hours will be undertaken.

For more information or to ask for a job to be done phone: **Housing Renewal Team 01508 533705**

Day Centre Driver Wanted

Volunteer driver needed to help at the Day Centre. For more details please contact:

**Mrs Doreen Steel - Tel: 01603 43699
Mob: 07951146362**

